

SOLD BY
STC

archer
bassett
LETTINGS AND SALES



Pandora Road, Henley Green, Coventry CV2 2FW
Offers In The Region Of £140,000

archerbassett
LETTINGS AND SALES

Situated within close proximity to the University Hospital and easy access to the motorway network this spacious three bedroom End Of Terraced home requires full refurbishment though out. In brief the property comprises of a kitchen/diner, a good size lounge and to the first floor are two double bedrooms, a good size single bedroom, shower room with shower cubicle & hand wash along with a separate W/C. Other features include double glazing, electric heating, gardens front & rear and a garage.

Viewings are strictly by appointment only via Archer Bassett.

Kitchen Diner

17'11" x 8'10" (5.48m x 2.70)

Spacious kitchen diner with wall & base units.

Lounge

17'11" 10'11" (5.48m 3.33m)

Spacious lounge spanning from the front to the rear of the property.

Bathroom

5'6" 6'3" (1.69m 1.92m)

Tiled bathroom with shower cubicle, hand wash & separate W/C.

Bedroom One

8'11" x 14'2" (2.72m x 4.34m)

Large principle bedroom with storage cupboard & dual aspect windows.

Bedroom Two

9'2" 8'10" (2.80m 2.70m)

Further double bedroom with storage cupboard.

Bedroom Three

5'11" x 10'11" (1.81m x 3.34m)

Generous single bedroom with storage cupboard

Tenure (Freehold)

The agent has been informed that the property is offered freehold however any interested party should obtain confirmation of this via their own solicitor or legal representative.

Viewing Arrangements

DISCLAIMER

The details for this property advert are believed to be accurate but not all items shown in the photographs may be included and interested parties must not rely upon this advert or any other statement as being a representation of fact and must satisfy themselves by inspection or otherwise to the correctness of each of them. Archer Bassett, or any of its employees, has authority to make or give any representation or warranty whatsoever in relation to the property. All verbal statements made in the course of negotiations are made on the same understanding. This advert does not form part of any contract not does it constitute property particulars.

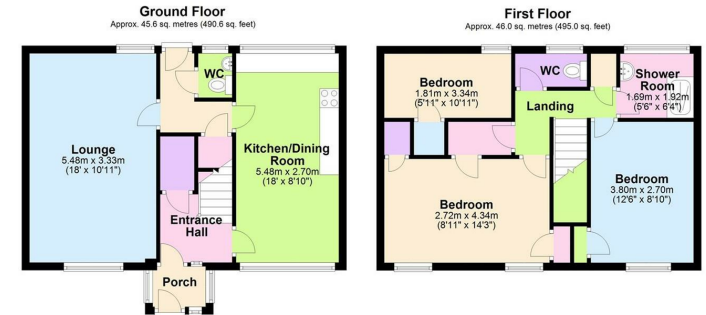

Total area: approx. 91.6 sq. metres (985.6 sq. feet)

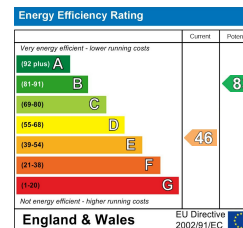
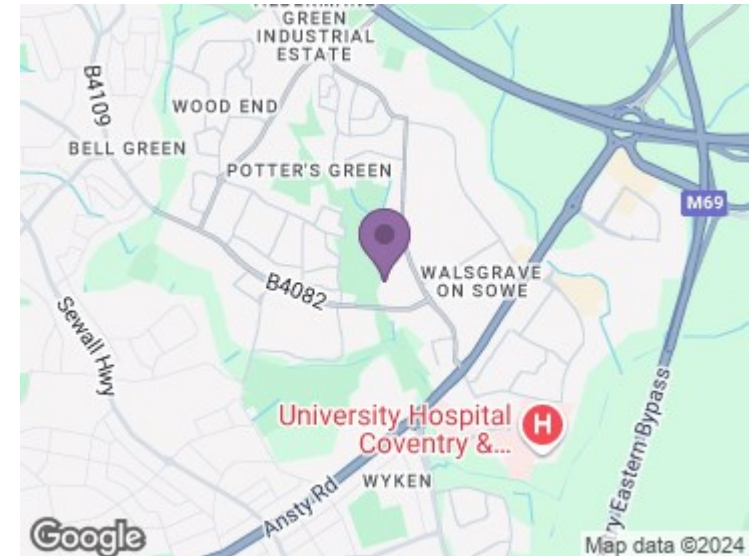

67 Hertford Street, Coventry CV1 1LB
024 7623 7500
 sales@archerbassett.co.uk
 archerbassett.co.uk