

LET BY

archer
bassett
LETTINGS AND SALES



Kinlet Close, Daimler Green, Coventry CV6 3LS
£995 Per Calendar Month

archerbassett
LETTINGS AND SALES

*****FULLY REDECORATED - NEW CARPETS & FLOORING*** A**

three bedroom end of terrace home located in a quiet cul-de-sac, close to the city centre benefiting from double glazing and gas central heating. In brief the property comprises of an entrance hall with a ground floor cloak room with W/C & hand wash, spacious lounge/diner with laminate flooring & French doors opening out to the rear garden, a fitted kitchen with integrated electric oven & gas hob. To the first floor are three bedrooms and a family bathroom with white suite, bath and shower over. Externally there is an enclosed rear garden and to the front there is a parking space & allocated visitors space. KIDS OK. PETS NO.

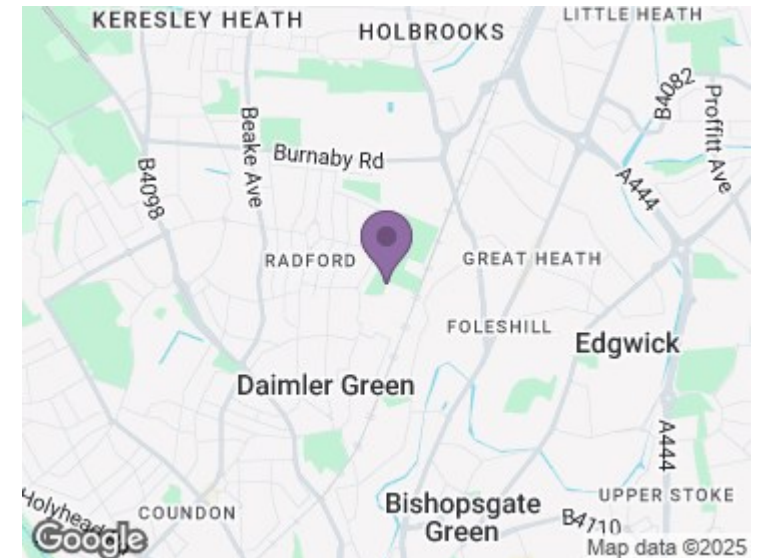
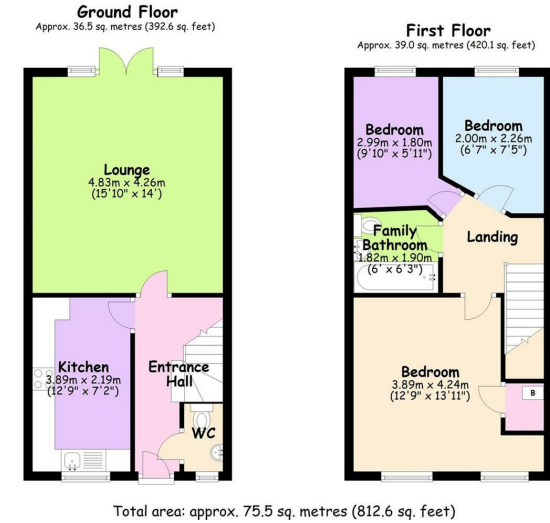

DISCLAIMER

The details for this property advert are believed to be accurate but not all items shown in the photographs may be included and interested parties must not rely upon this advert or any other statement as being a representation of fact and must satisfy themselves by inspection or otherwise to the correctness of each of them. Archer Bassett, or any of its employees, has authority to make or give any representation or warranty whatsoever in relation to the property. All verbal statements made in the course of negotiations are made on the same understanding. This advert does not form part of any contract not does it constitute property particulars.

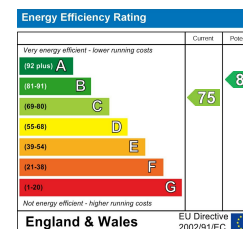

67 Hertford Street, Coventry CV1 1LB
024 7623 7500
 sales@archerbassett.co.uk
 archerbassett.co.uk